

# ECO NOVA 31

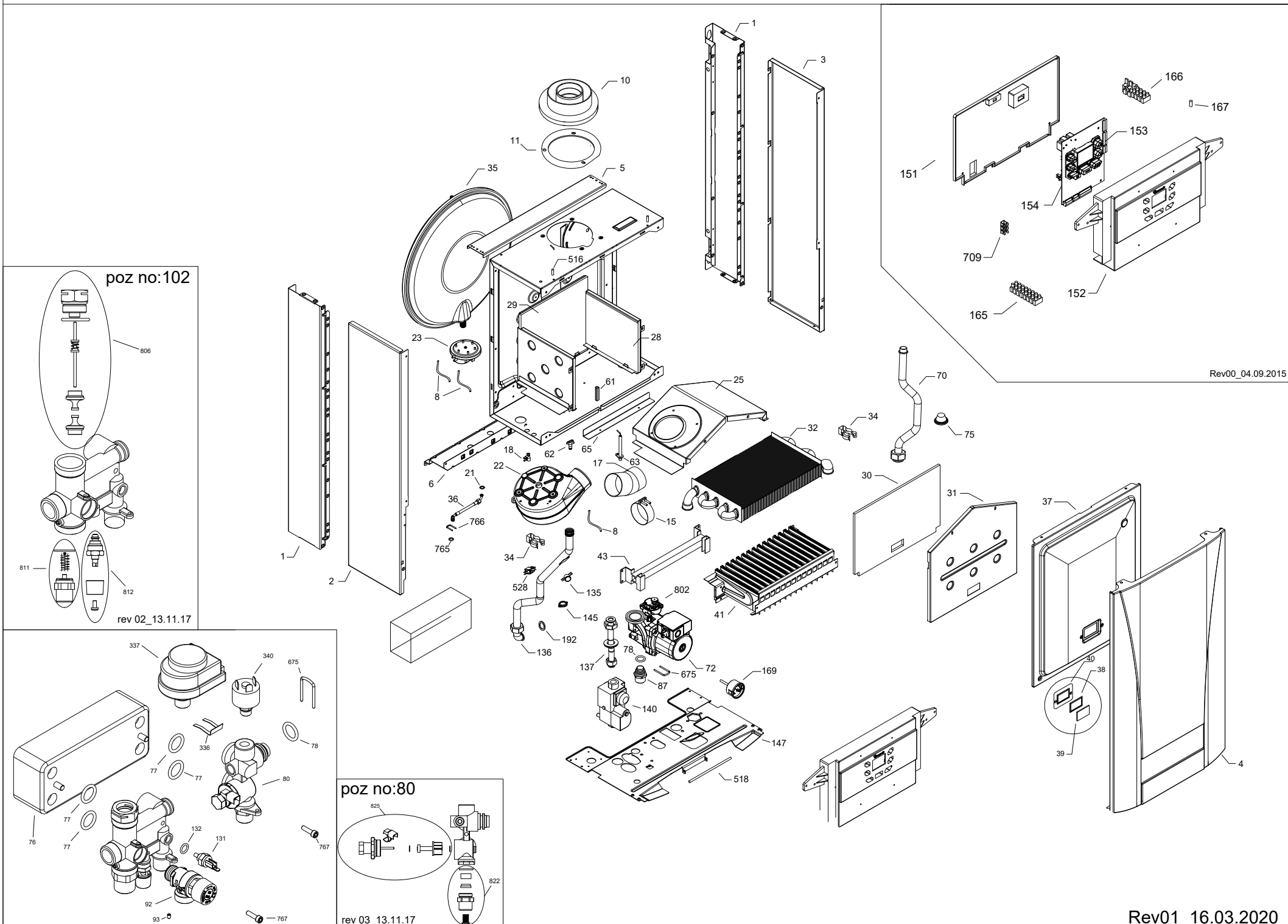

REV01\_15.05.2020

POS NO	PART CODE	DEFINITION	ECO NOVA 31
1	TTT005683092	REAR SIDE PANEL	X
2	6602813031	LEFT SIDE PANEL	X
3	6602813032	RIGHT SIDE PANEL	X
4	6302251281	FRONT PANEL	X
5	SSS005110293	SIDE PANEL CONNECTION BRACKET	X
6	YYY005115071	EXPANSION VESSEL SUPPORT	X
8	YYY005408081	PRESSURE FEEDBACK HOSE L:270	X
10	YYY005207062	FLUE ADAPTER	X
11	YYY005407892	FLUE ADAPTER GASKET	X
15	6610243125	FAN CLAMP	X
17	6310350006	FAN ELBOW	X
18	YYY005413851	FAN PRESSURE ADAPTER	X
21	YYY005402052	GASKET 6.1X11.5X1.5	X
22	YYY009951202	FAN	X
23	YYY005700882	AIR PRESSURE SWITCH	X
25	6302211284	PADDLE BOX	X
28	6308110163	COMBUSTION CHAMBER SIDE INSULATION	X
29	6308110164	COMBUSTION CHAMBER REAR INSULATION	X
30	6308110162	COMBUSTION CHAMBER COVER INSULATION	X
31	6302211285	COMBUSTION CHAMBER FRONT PANEL	X
32	63041310061P	MAIN HEAT EXCHANGER	X
34	YYY009952031	CLIPS-MAIN HEAT EXCHANGER	X
35	200024700	EXPANSION VESSEL 10LT	X
36	6310310719	EXPANSION VESSEL FLEX HOSE	X
37	6613223178	HERMETIC BODY COVER WITH INSULATION	X
38	YYY005401611	SIGHT GLASS GASKET	X
39	YYY005203932	SIGHT GLASS	X
40	SSS005115591	SIGHT GLASS FRAME	X
41	200024394	BURNER 15NP	X
43	200024390	MANIFOLD 15NP	X
61	6312140228	ELECTRODE GASKET	X
62	YYY005409572	PRESSURE MEASURING ADAPTER	X
63	0611410032	IGNITION ELECTRODE	X
65	6302211276	HERMETIC BODY AIR ROUTER SHEET METAL	X
70	6310311373	MAIN HEAT EXCHANGER INLET PIPE	X
72	63104010351P	CIRCULATION PUMP KR 15-60 (IHR)	X
75	YYY005404671	HERMETIC BODY GASKET	X
76	63041310441P	PLATE HEAT EXCHANGER	X
77	6399440051	O-RING 3,6X19X25	X
78	6399440057	O-RING 17X4	X
80	6310410054	INLET MANIFOLD	X
87	6311240061	PUMP NIPPLE	X
92	6306101022	3 BAR SAFETY VALVE	X
93	0599150076	SETSCREW M4X6	X
102	63104100551P	OUTLET MANIFOLD	X
131	YYY84354011P	NTC SENSOR DHW	X
132	YYY005402833	GASKET 9.7X15X2	X
135	YYY99516121P	SAFETY TEMPERATURE VALVE 105C	X
136	6310311372	MAIN HEAT EXCHANGER OUTLET PIPE	X
137	6310311380	GAS PIPE	X
140	63064600141P	GAS VALVE	X
145	6302530014	LIMIT THERMOSTAT HOLDER	X
147	6310221094	BOTTOM FRAME	X

POS NO	PART CODE	DEFINITION	ECO NOVA 31
151	6302310312	CONTROL PANEL PLASTIC REAR COVER	X
152	YYYYY	CONTROL PANEL PLASTIC	X
153	6602310009	PCB PUSH BUTTON	X
154	06053401581P	PCB DM3219	X
165	710117901	KLEMENS	X
166	YYY005688431	KLEMENS WITH FUSE	X
167	6605500001	FUSE	X
169	YYY009951651	MANOMETER	X
192	YYY005404652	GASKET 3/4"	X
336	YYY008380681	3WV CLIPS	X
337	YYY005694581	3WV MOTOR	X
340	YYY009951692	PRESSURE SWITCH	X
518	YYY005112041	PIN L:150MM	X
528	06054000151P	NTC SENSOR CH	X
675	6301431007	CLIPS - PUMP NIPPLE	X
709	YYY008421821	FASTON	X
765	6399440050	O-RING 3X14X20	X
766	6301431008	CLIPS 3X20X32	X
767	0599130079	HEX SCREW M5X20	X
802	6606100001	PUMP AIR PURGE	X
806	200024701	3WV GROUP	X
811	6610410006	CH OUTLET NIPPLE	X
812	6610410007	FILLING VALVE PART WITH GASKET GROUP	X
822	6610410017	INLET MANIFOLD NIPPLE	X
825	200024693	TURBINE PIN GROUP WITH FLOW SENSOR	X
999	6306101026	INJECTOR 1,28 (NG)	X
999	6306101027	INJECTOR 0,77 (LPG)	X
999	6306101021	INJECTOR WASHER (LPG)	X
999	YYY008414541	GROUND CABLE L:54	X
999	6305100041	GROUND CABLE GROUP	X
999	YYY008414541	GROUND CABLE L:54	X
999	6305100064	LOW VOLTAGE CABLE-APS-HLS	X
999	6305100034	GAS VALVE SUPPLY CABLE	X
999	6305100037	GAS VALVE MODULATION CABLE	X
999	6305100065	HIGH VOLTAGE CABLE GROUP	X
999	YYY008414622	SUPPLY CABLE	X
999	6305100042	IGNITION CABLE	X
999	6305100035	3WV MOTOR CABLE	X
999	6305100039	LOW VOLTAGE CABLE-DHW NTC-PS	X
999	0599120130	SCREW DOWEL SET	X
999	6302211294	FLUE RESTRICTOR 60/44	X