

# ECO NOVA 24

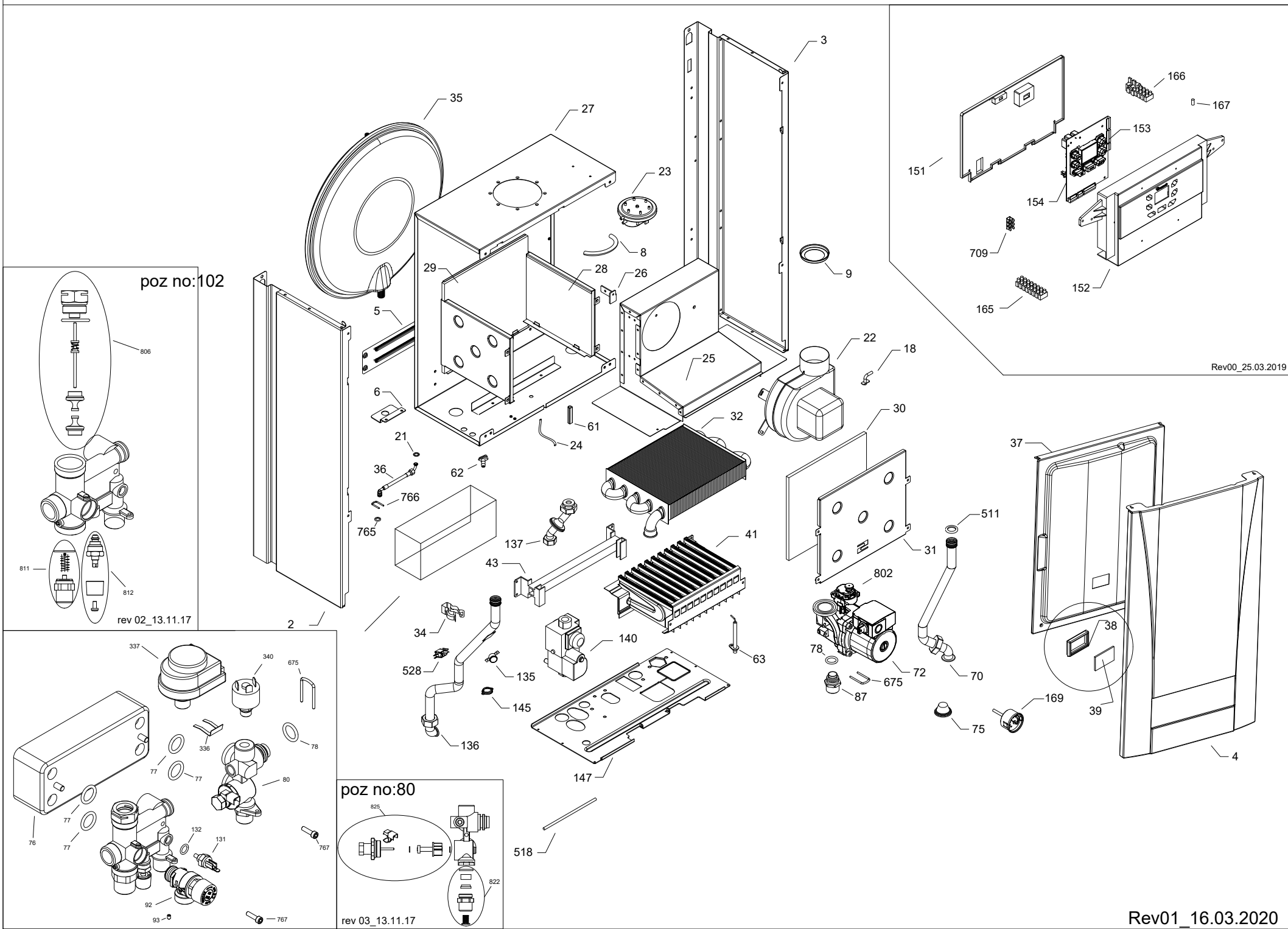

POS. NO	CODE	DEFINITION	ECO NOVA 24
2	6602813036	LEFT SIDE PANEL	X
3	6602813037	RIGHT SIDE PANEL	X
4	6302251280	FRONT PANEL	X
5	SSS005117421	SIDE PANEL BRACKET	X
6	6310211114	EXPANSION VESSEL SUPPORT	X
9	6302211280	FLUE RESTRICTOR	X
18	6603220001	FAN PRESSURE ADAPTER	X
21	YYY005402052	GASKET 6.1X11.5X1.5	X
22	63111300821P	FAN	X
23	YYY57008821P	AIR PRESSURE SWITCH	X
24	YYY005407931	PRESSURE FEEDBACK HOSE	X
25	6302213076	PADDLE BOX	X
28	6308110151	COMBUSTION CHAMBER SIDE INSULATION	X
29	6308110149	COMBUSTION CHAMBER REAR INSULATION	X
30	6308110150	COMBUSTION CHAMBER FRONT INSULATION	X
31	6313221592	COMBUSTION CHAMBER FRONT PANEL	X
32	200024030	MAIN HEAT EXCHANGER_6304131045	X
34	YYY009952031	CLIPS-MAIN HEAT EXCHANGER	X
35	YYY56952311P	EXPANSION VESSEL	X
36	6310310719	EXPANSION VESSEL FLEX HOSE	X
37	200025135	HERMETIC BODY COVER WITH INSULATION_V2	x
38	6312140204	SIGHT GLASS GASKET	X
39	6302150042	SIGHT GLASS 3X34X54	X
41	200024393	BURNER_6311500003	X
43	200024386	BURNER MANIFOLD_6310310697	X
61	300034678	ELECTRODE GASKET_V2	x
62	YYY005409572	PRESSURE MEASURING ADAPTER	X
63	611410032	IGNITION ELECTRODE	X
70	6310310720	MAIN HEAT EXCHANGER INLET PIPE	X
72	63104010341P	CIRCULATION PUMP	X
75	YYY005404671	HERMETIC BODY GASKET	X
76	63041310091P	PLATE HEAT EXCHANGER	X
77	6399440051	O-RING 3,6X19X25	X
78	6399440057	O-RING 17X4	X
80	6310410054	INLET MANIFOLD	X
87	6311240061	PUMP NIPPLE	X
92	6306101022	3 BAR SAFETY VALVE	X
93	0599150076	SETSCREW M4X6	X
102	63104100551P	OUTLET MANIFOLD	X
131	YYY84354011P	NTC SENSOR DHW	X
132	YYY005402833	GASKET 9.7X15X2	X
135	YYY99516121P	SAFETY TEMPERATURE VALVE 105C	X
136	6310310718	MAIN HEAT EXCHANGER OUTLET PIPE	X
137	6310310737	GAS PIPE	X
140	63064600141P	GAS VALVE	X
145	6302530014	LIMIT THERMOSTAT HOLDER	X
147	6310221089	BOTTOM FRAME	X

151	6302310312	CONTROL PANEL PLASTIC REAR COVER	X
152	XXXXX	CONTROL PANEL PLASTIC	X
153	300031348	PCB PUSH BUTTON DM3219	X
154	06053401581P	PCB DM3219	X
165	710117901	KLEMENS	X
166	YYY005688431	KLEMENS WITH FUSE	X
169	YYY99516511P	MANOMETER	X
336	YYY008380681	CLIPS-3WV MOTOR	X
337	YYY56945811P	3WV MOTOR	X
340	YYY99516921P	PRESSURE SWITCH	X
511	7112306	O-RING 17.13x2.62 EP 70 SHORE	X
518	YYY005112041	PIN L:150MM	X
528	06054000151P	NTC SENSOR CH	X
675	6301431007	CLIPS - PUMP NIPPLE	X
709	YYY008421821	FASTON	X
765	6399440050	O-RING 3X14X20	X
766	6301431008	CLIPS 3X20X32	X
767	0599130079	HEX SCREW M5X20	X
802	6606100001	PUMP AIR PURGE	X
806	200024701	3 WAY VALVE CARTRIDGE GROUP	X
811	6610410006	OUTLET MANIFOLD NIPPLE	X
812	6610410007	FILLING VALVE PART WITH GASKET GROUP	X
822	6610410017	INLET MANIFOLD NIPPLE	X
825	200024693	TURBINE PIN GROUP WITH FLOW SENSOR	X
999	6305100064	LOW VOLTAGE CABLE GROUP	X
999	6305100037	GAS VALVE MODULATION CABLE	X
999	6305100034	GAS VALVE SUPPLY CABLE	X
999	6305100039	NTC SENSOR CABLE	X
999	6305100041	GROUND CABLE GROUP	X
999	YYY008414541	GROUND CABLE L:54	X
999	6305100065	HIGH VOLTAGE CABLE GROUP	X
999	6305100035	3WV MOTOR CABLE	X
999	6305100042	IGNITION CABLE	X
999	YYY008414622	SUPPLY CABLE	X
999	6606103018	LPG KIT ECO/ML24/ME25/ME21 (Ø 0,80)	X